

E-BIKESTRADA

Compact, lightweight folding electric bike



User manual



E-BIKESTRADA

Specification

Bike

Weight:	20 kg
Wheel size:	20"
Maximum speed:	25 km/h
Range:	Up to 40km (with pedal assist)

Battery

Type:	lithium
Voltage:	24V
Capacity:	8.5h

Motor

250W 24V

Charger

Input Voltage:	AC100V-240V 50HZ-60HZ
Output:	29.4V/2.0A
Charging Time:	5~8h

E-BIKE STRADA

PLEASE READ! General maintenance and safety advice

- 1) Users of E-BIKE STRADA should observe local road and traffic regulations for standard bicycles in force in the country of use at all times.
- 2) Please read this manual before using E-BIKE STRADA
- 3) Ensure that the power switch on the handlebar is switched off when the E-BIKE is not use.
- 4) The seat post should not be raised beyond the safety line indicated. Please note that the tightening torque of the saddle's grip nut and post's clamping bolt is 18N.m.
- 5) The handlebar post should not be raised beyond the safety line indicated. Please note that the tightening torque of screw rod for handle and the torque of horizontal road fixing bolt is 18N.m.
- 6) Always check that the front and rear brakes are working correctly and that the tyre pressures are correct before riding E-BIKE STRADA.
- 7) The tightening torques of the front and the rear hub nuts are 18N.m and 30N.m respectively.
- 8) Do not wash your E-BIKE STRADA with the battery charger connected to the battery whilst charging to prevent the possibility of electric shocks.
- 9) Do not submerge the battery in water. Do not ride your E-BIKE through water deeper than 8" or 20 cm.
- 10) Do not tamper with the electrical control unit on your E-BIKE STRADA. This could endanger the rider and will invalidate the warranty.
- 11) Approximately every 6 months it is important to clean and lubricate the front, back and middle axles, flywheel, and front forks plus other moving parts with a good quality grease.

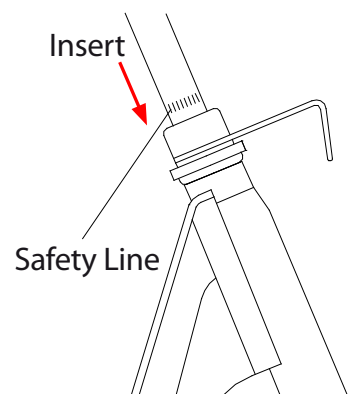
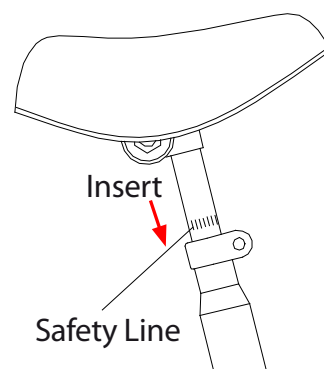

(insert seat post until safety line can no longer be seen)

Quick start guide

- Charge the battery following the battery charging instructions below.
- Adjust the height of the seat and handlebars to your preferred position ensuring that you do not exceed the height safety line indicated on the seat post and handlebar post.
- Check that the tyre's have been inflated to the correct pressure and that the front and rear brakes operate correctly. Please refer to the section below explaining how to adjust the brakes as necessary.
- Next power on the P.A.S. (Pedal Assist System) A red LED will indicate that the device is powered on.



- Use the + and – buttons to select the amount of pedal assistance required.
- The battery level indicator will inform you of how much power is left in the battery.
- Your E-BIKE STRADA is now ready to use. Ride your E-BIKE as you would a normal bicycle but as you pedal you will feel the bike's motor providing gentle assistance depending on the level of pedal assistance set.

Please note: Your E-BIKE STRADA has a range of up to 40km. This range will be determined by the amount and severity of slope on your route, the weight of the rider, correct tyre pressure, opposing wind and the amount of pedal operation by the rider themselves.

- To conserve battery power please ensure you switch the battery off when not in use.



Battery On/Off Switch

Riding without pedal assistance.

- It is possible to ride your E-BIKE STRADA like a normal bike. To deactivate the P.A.S. simply switch the pedal assist off and switch off the battery using the battery on/off switch.

Battery and charger safety advice

- Please save this manual as it contains important operating and safety information about the battery and charger.
- Please read this manual before using the battery and charger, including the warning label on the charger and battery pack.
- Do not expose the battery charger to rainy or wet conditions or operate in temperatures below 0°C or above 35°C as this may damage the charger.
- Only use the charger supplied to charge the battery supplied with your E-BIKE STRADA. Do not use the charger supplied to charge any other battery.
- Do not attempt to lengthen the power cable supplied with the charger or to open and tamper with the charger in any way.
- Do not store the battery in an environment which could exceed 50°C – in the car in summer for example, as it may adversely affect the performance of the battery.
- Do not throw the battery pack into fire, as there is a risk of explosion.
- Only operate the charger according to the INPUT and OUTPUT values marked on the rating label.
- Ensure that the battery charger is well ventilated and do not cover during charging.
- Store the battery in a safe and dry place when not in use. To maintain battery quality during long periods of inactivity, fully charge the battery every 2 to 3 months.

Charging the battery

- The battery is located inside the bicycle cross member and does not need to be removed for charging.

Please note: when charging the battery for the first time, please charge for 10 hours to ensure that the battery is fully charged and conditioned.

- Connect the charger to the bicycle by lifting the plastic cover to reveal the charging socket - located on the cross member on the opposite side to the on/off switch.
- Connect the power plug of the charger to an appropriate AC outlet socket.

If you should need to remove or replace the battery

1. Fold the bicycle by releasing the retaining catch at the centre hinge.
2. Carefully lift the battery handle.
3. Slide the battery out of the frame.

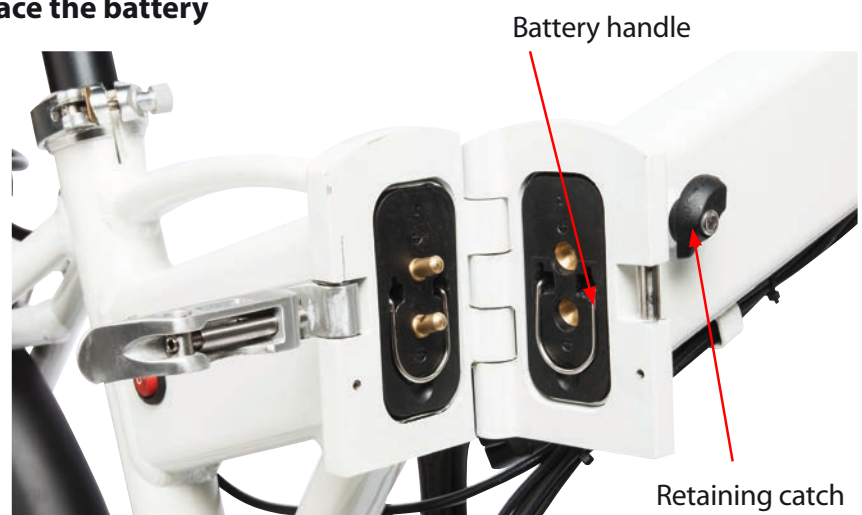

Adjusting the brakes

Examine the brakes on your E-BIKE regularly to ensure they are working correctly as follows:

Adjusting the front and rear brake

- 1.1 Check the right brake lever as per the picture. Full braking should be reached when the lever reaches the halfway point indicated by the 'X'.
- 1.2 Loosen the screw on the braking cable seat as per the picture.. Then tighten or loosen the braking cable, enabling the average stroke between the two brake blocks and the rims so it is approximate 1.5mm to 2mm.

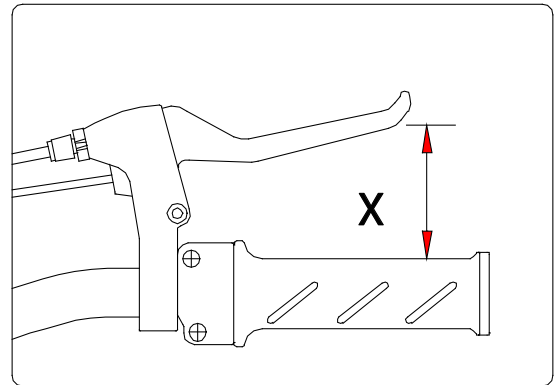

1. Brake arm
2. Brake block
3. Spring adjusting screw
4. Braking cable seat
5. Braking cable

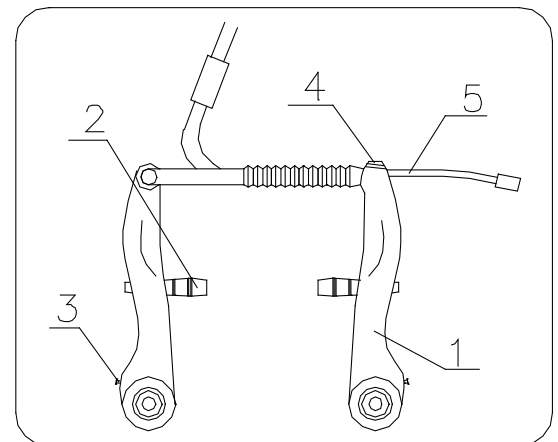

Controls:

Left Hand



Right Hand



Troubleshooting

PROBLEM/ QUESTION	TROUBLE DESCRIPTION CAUSES	TROUBLE SHOOTING METHODS
The power LED is not illuminated and the bicycle doesn't start when the switch is turned on.	<ul style="list-style-type: none">● Poor contact between the electrodes of the battery box.	<ul style="list-style-type: none">● Check for dirt on the electrodes of the battery box or seat, and remove it.
The motor runs immediately once the E-BIKE is powered on. (Note: immediately power off the switch to avoid accident.)	<ul style="list-style-type: none">● The speed-adjusting handle is not reset.● The controller is damaged.	<ul style="list-style-type: none">● Check whether the speed-adjusting handle is operating correctly and reset if necessary.
E-BIKE is slow when riding or pedal assist range is short.	<ul style="list-style-type: none">● The tyres are not inflated enough.● Frequent starts, hills and slopes on route or riding against the wind.● Battery capacity is in decline or there is a fault with the battery.	<ul style="list-style-type: none">● Check tyres are properly inflated.● Increase the amount of pedaling independent of PAS while riding on flat areas.● Replace battery with the new.

IMPORTANT!

We reserve the right to make modifications to E-BIKE without prior notice.



Performance Products Ltd, Cleaver House, Sarus Court, Manor Park, Runcorn WA7 1UL. Tel 0333 240 1000 Fax 0333 240 1100

www.snooper.co.uk